

# WALL MOUNTED CORNER BASIN



## CORNER BASIN

### Overall Dimensions:

268 (w) x 268 (d) x 165 mm (h)

**Splashback Height:** 25 mm

### Bowl Size:

230 mm diameter x 120 mm (h)

**Capacity:** 2.5 L

### Shipping Dimensions:

310 (w) x 300 (d) x 190 mm (h)

**Shipping Weight:** 2 kg

**Material:** 2 mm food-grade 304 stainless steel on the top.

**PRODUCT CODE:** HBC

 Brayco Stainless Steel is made from 95% recycled materials

FRONT

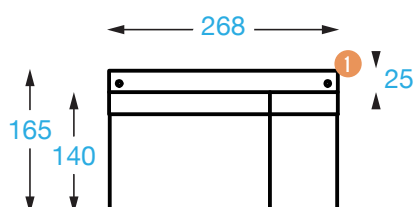

TOP

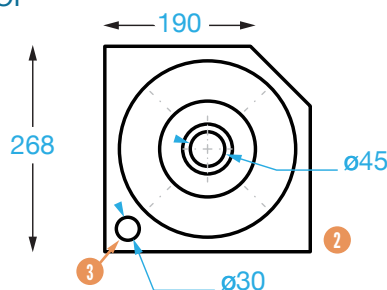

ANGLE

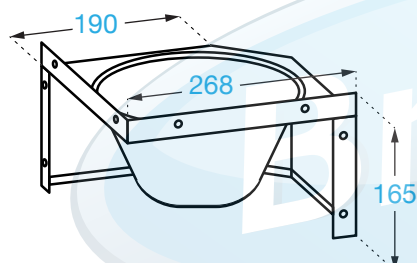

## FEATURES AND BENEFITS

- Wall Mounted
- Corner Mounted
- **Construction:** Our units are fully stainless steel. Very sturdy.
- **Bowl:** Fully welded for strength and superior durability.
- **Tap Location:** Pre-drilled ø30 mm hole for tap.
- Sink Drainer Included

### COMPONENTS

- 1 Splashback
- 2 Fully welded bowls
- 3 Pre-drilled hole for tap

### DIMENSIONS

25 mm

2.5 ltr capacity

ø30 mm

Please note: Hole for tap may need filing slightly to ensure your tap fits.



These products are compliant with all applicable Australian health department regulations.



It is important that your stainless steel is kept clean to extend the lifetime of the product.



Brisbane • Sydney • Melbourne • Hobart • Adelaide • Perth • Auckland  
For more info please contact your nearest Brayco Branch 1300 272 926 | [brayco.com.au](http://brayco.com.au)